

**UNITED STATES DEPARTMENT OF AGRICULTURE
NATURAL RESOURCES CONSERVATION SERVICE AND
VOLUSIA COUNTY ENVIRONMENTAL MANAGEMENT**

RECTANGULAR FARM POND

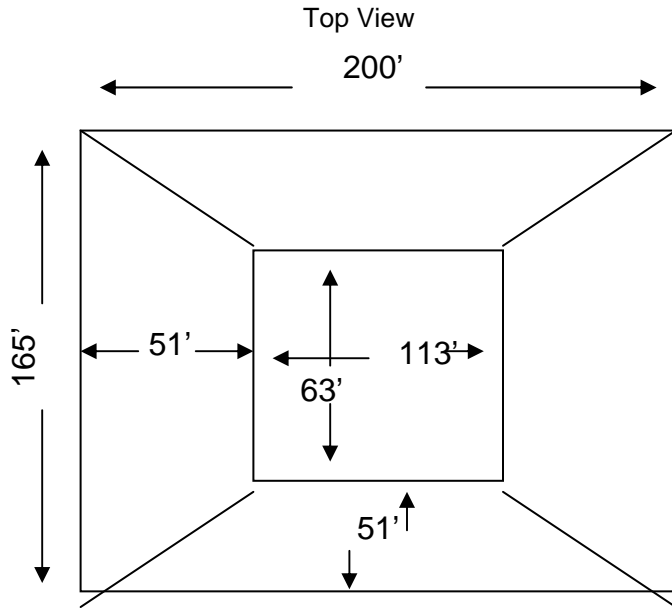

Side View - Length
Standard cross-section

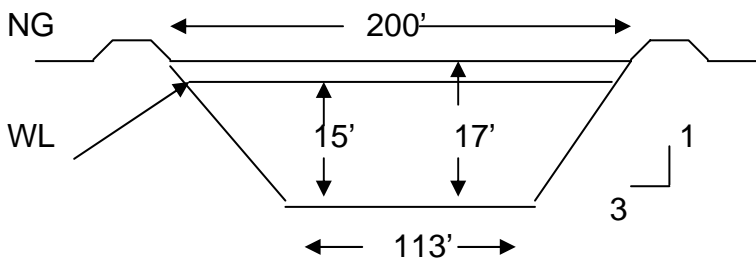

Front View
Standard cross-section

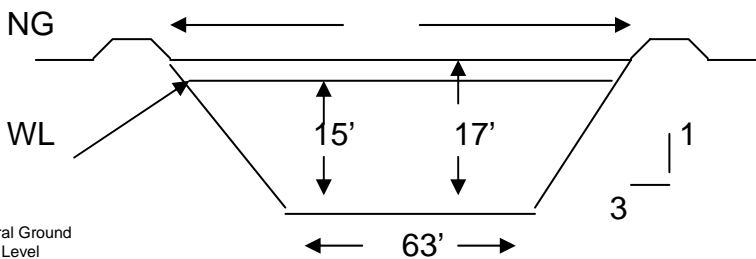

NG - Natural Ground
WL - Water Level

Classification = $\frac{3}{4}$ Farm Pond

Pond length = 200'

Pond width = 163'

Pond depth = 17'

Side Slopes = 3:1

Water table assumed at
2' below natural ground (NG)

Total excavation volume =
12,064.815 cu. yds.

Total water volume =
1,808,910 gallons

Total surface area =
32,600 sq. ft.