

**UNITED STATES DEPARTMENT OF AGRICULTURE
NATURAL RESOURCES CONSERVATION SERVICE AND
VOLUSIA COUNTY ENVIRONMENTAL MANAGEMENT**

SQUARE FARM POND

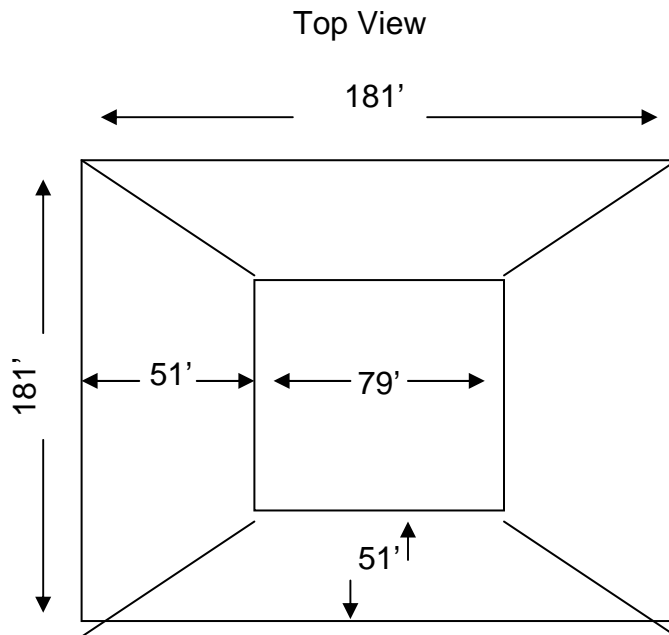

Classification = $\frac{3}{4}$ Farm Pond

Pond length = 181'

Pond width = 181'

Pond depth = 17'

Side Slopes = 3:1

Water table assumed at
2' below natural ground (NG)

Total excavation volume
= 11,186.63 cu. yds.

Total water volume =
10,650.56 cu. yds.
or 2,151,412 gal.

Total surface area =
32,668 sq. ft.

Side View
Standard cross-section

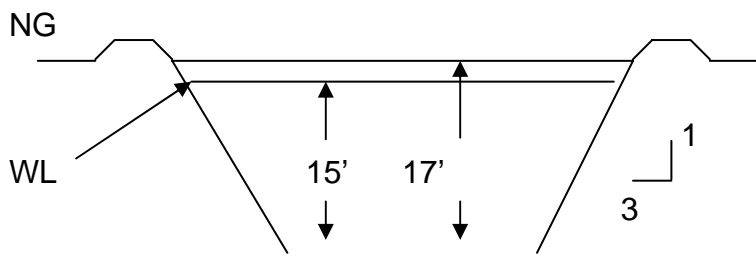

NG - Natural Ground
WL - Water Level